



MEMORANDUM

301 W. MAIN ▪ OWOSSO, MICHIGAN 48867-2958 ▪ WWW.CI.OWOSSO.MI.US

DATE: January 15, 2020
TO: Owosso City Council
FROM: Glenn Chinavare, Director of Public Services & Utilities
SUBJECT: Setting Public Hearing for Special Assessment Roll for North Street Reconstruction

RECOMMENDATION:

Approval of Resolution No. 4, setting second public hearing for North Street Reconstruction Project.

BACKGROUND:

This public hearing is intended to provide affected residents with the opportunity to comment regarding their individual assessments.

Step Four/Resolution No. 4 takes place after the bids are received. Estimated assessment amounts are adjusted if necessary to reflect the actual cost as dictated by the bids received. A second public hearing is set to allow property owners to comment on their particular assessment. Each property owner is sent a second notice containing the date and time of the public hearing and the amount of the proposed assessment for their property. City Council sets the second public hearing at its **January 21, 2020** meeting.

Step Five/Resolution No. 5 documents the second public hearing, finalizes the special assessment roll and sets the terms of payment. This public hearing is designed to allow affected citizens the opportunity to argue whether or not the amount of their assessment is fair and equitable in relation to the benefit they receive from the project. If, after hearing citizen comment, the council decides adjustments need to be made to the assessment roll they may do so. Alternately, if it is felt all the assessments are fair and equitable the resolution may be passed as written.

Tonight the council will be considering Resolution No. 4 for the proposed district as a part of the Consent Agenda. Staff recommends authorization of Resolution No. 4 setting a public hearing for Monday, **February 3, 2020** to receive citizen comment regarding the proposed special assessment roll for the following public improvement:

North Street, a Public Street, from Hickory Street to Gould Street

Attachment(s): North Street Resolution No. 4
North Street Special Assessment Roll
North Street Engineer's Estimate

RESOLUTION NO.

**SPECIAL ASSESSMENT DISTRICT NO. 2020-03
NORTH STREET
FROM HICKORY STREET TO GOULD STREET
SPECIAL ASSESSMENT RESOLUTION NO. 4**

WHEREAS, the Assessor has prepared a special assessment roll for the purpose of specially assessing that portion of the cost of the public improvements more particularly hereinafter described to the properties specially benefited by said public improvement, and the same has been presented to the Council by the City Clerk.

NOW, THEREFORE, BE IT RESOLVED THAT:

1. Said special assessment roll is hereby accepted and shall be filed in the office of the City Clerk for public examination.
2. The Council shall meet at the Owosso City Hall, Owosso, Michigan at 7:30 o'clock p.m., on Monday, February 3, 2020 for the purpose of hearing all persons interested in said special assessment roll and reviewing the same.
3. The City Clerk is directed to publish the notice of said hearings once in the *Argus Press*, the official newspaper of the City of Owosso, not less than ten (10) days prior to said hearing and shall further cause notice of said hearing to be sent by first class mail to each owner of the property subject to assessment, as indicated by the records in the City Assessor's office as shown on the general tax rolls of the City, at least ten (10) days before the time of said hearing, said notice to be mailed to the addresses shown on said general tax rolls of the City.
4. The notice of said hearing to be published and mailed shall be in substantially the following form:

**NOTICE OF HEARING
TO REVIEW SPECIAL ASSESSMENT ROLL
CITY OF OWOSSO, COUNTY OF SHIAWASSEE, MICHIGAN**

TO THE OWNERS OF THE FOLLOWING DESCRIBED PROPERTY:

NORTH STREET, A PUBLIC STREET, FROM HICKORY STREET TO GOULD STREET

TAKE NOTICE that a Special Assessment roll has been prepared for the purpose of defraying the Special Assessment district's share of the cost of the following described improvements:

STREET RECONSTRUCTION

The said Special Assessment roll is on file for public examination with the City Clerk and any objections to said Special Assessment roll must be filed in writing with the City Clerk prior to the close of the hearing to review said Special Assessment roll.

TAKE FURTHER NOTICE that appearance and protest at this hearing is required in order to appeal the amount of the special assessment to the State Tax Tribunal if an appeal should be desired. A property owner or party in interest, his or her agent, may appear in person at the hearing to protest the special assessment or may file his or her appearance by letter and his or her personal appearance shall not be required. The property owner or any person having an interest in the property subject to the proposed special assessments may file a written appeal of the special assessment with the State Tax Tribunal within thirty days after confirmation of the special assessment roll if that special assessment was protested at this hearing.

TAKE FURTHER NOTICE that the City Council will meet at the Owosso City Hall, Owosso, Michigan at 7:30 p.m. on Monday, February 3, 2020 for the purpose of reviewing said special assessment roll and for the purpose of considering all objections to said roll submitted in writing.

City of Owosso

Proposed Special Assessment

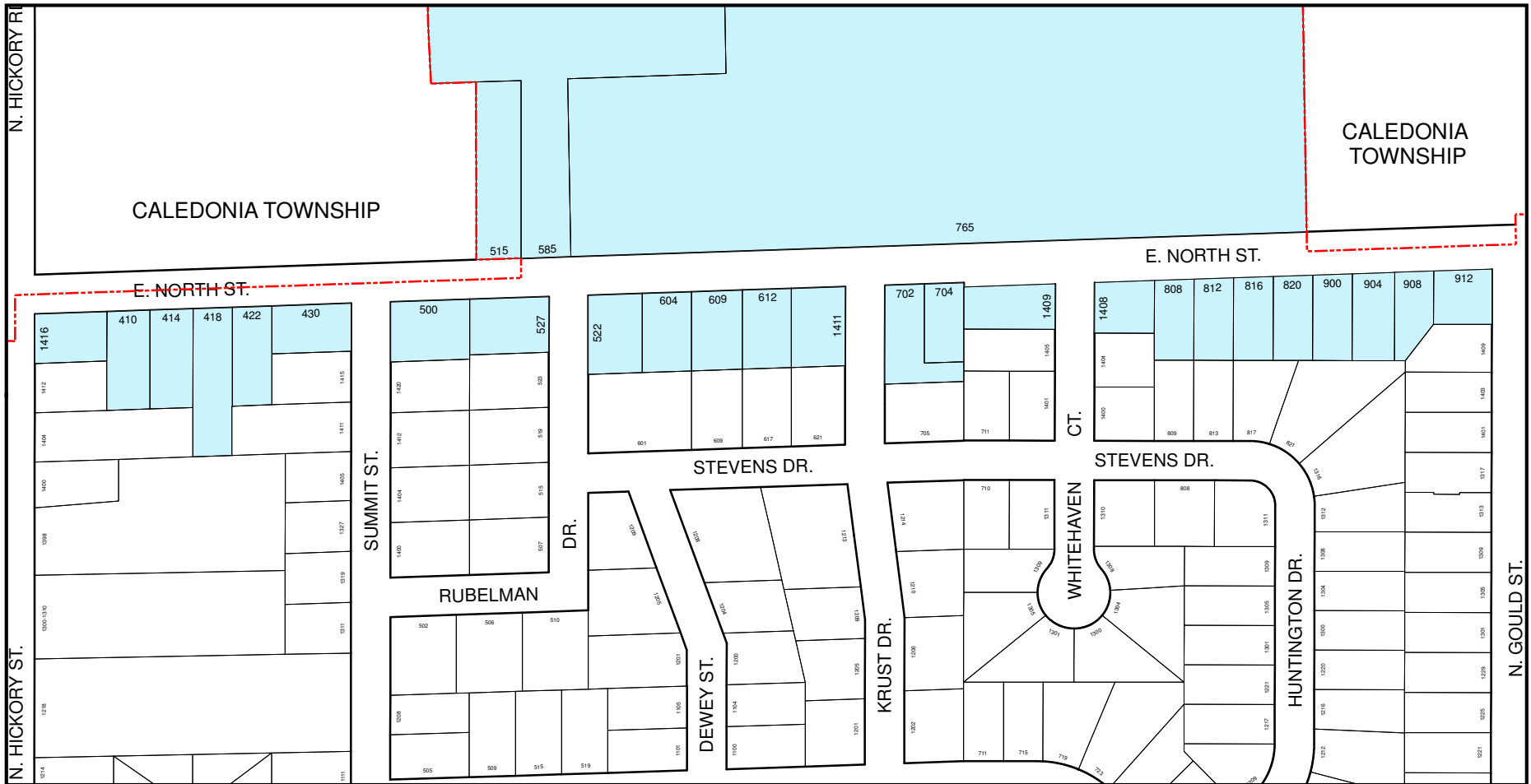

E. North Street from Hickory St. to Gould St.

Legend

- Parcels
- Special Assessment Parcels
- CityLimit
- 1501 Street Address Number

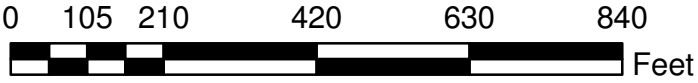

1 inch = 264 feet



**POST BID ASSESSMENT CALCULATIONS
NORTH STREET**

E NORTH STREET FROM HICKORY TO GOULD

SPECIAL ASSESSMENT DISTRICT NO. 2020-03 ROLL

RESO 4

ENGINEER'S ESTIMATE ASSESSABLE AMOUNT	\$623,201.28
TOTAL ASSESSABLE FRONT FEET	4329.81

CALCULATING ASSESSABLE FRONT FOOT RATE AND AMOUNTS:

PROPERTY TYPE	RESIDENTIAL PROPERTY	COMMERCIAL PROPERTY	TOTAL
TOTAL ASSEMENT PER TYPE	\$623,201.28	\$623,201.28	
CITY SHARE \geq 60%	\$423,791.23	\$385,465.32	
PROPERTY SHARE @ \leq 40%	\$199,410.05	\$237,735.96	
ASSESSABLE FRONT FOOT RATE: PROP SHARE/4329.81	\$46.06	\$54.91	
TOTAL FRONT FEET PER TYPE	2049.04	1228.27	
TOTAL AMOUNT OF ASSESSMENT PER TYPE:	\$94,368.72	\$67,440.44	\$161,809.16

SUMMARY: SPECIAL ASSESSMENT AMOUNTS PER SIDE OF STREET:

NORTH SIDE	\$74,744.82
SOUTH SIDE	\$87,078.04
TOTAL SPECIAL ASSESSMENT	\$161,822.86

NORTH SIDE

ADDRESS NO.	STREET	OWNER NAME	ROLL NUMBER	FRONT FOOTAGE	CORNER LOT DISCOUNT	ASSESSABLE FRONT FEET	FRONT FOOT RATE	AMOUNT OF ASSESSMENT	Zoning
	E NORTH	CALEDONIA TOWNSHIP		736.5	1	736.50		\$0.00	
515	E NORTH	FIRST CHURCH OF CHRIST	530-000-003	75	1	75.00	\$46.06	\$3,454.50	R1
585	E NORTH	FIRST CHURCH OF CHRIST	530-000-002	83.5	1	83.50	\$46.06	\$3,846.01	R1
765	E NORTH	OWOSSO PUBLIC SCHOOLS	530-000-001	1228.27	1	1228.27	\$54.91	\$67,444.31	R1*
	E NORTH	CALEDONIA TOWNSHIP		316	1	316.00		\$0.00	
				2439.27		2439.27		\$74,744.82	

SOUTH SIDE

ADDRESS NO.	STREET	OWNER NAME	ROLL NUMBER	FRONT FOOTAGE	CORNER LOT DISCOUNT	ASSESSABLE FRONT FEET	FRONT FOOT RATE	AMOUNT OF ASSESSMENT	Zoning
1416	N HICKORY	ZAMORA, RODOLFO L/FLANAGAN, PATTY A	140-000-020	120	0.75	90.00	\$46.06	\$4,145.40	R1
410	E NORTH ST	KALINA, THOMAS W	140-000-022	72	1	72.00	\$46.06	\$3,316.32	R1
414	E NORTH ST	PARTAIN, ERIC	140-000-023	72	1	72.00	\$46.06	\$3,316.32	R1
418	E NORTH ST	SIREKIS, DAWN	140-000-019	66	1	66.00	\$46.06	\$3,039.96	R1
422	E NORTH ST	PERRY, ANTHONY & PAMELA	140-000-018	66	1	66.00	\$46.06	\$3,039.96	R1
430	E NORTH ST	WALKER, JAMES R. & MARY E.	140-000-017	132	0.75	99.00	\$46.06	\$4,559.94	R1
500	E NORTH ST	HILGENDORF, HAROLD D & JACQULYN E	140-000-014	132	0.75	99.00	\$46.06	\$4,559.94	R1
527	RUBELMAN	SCRIMGER, JOSHUA & MARY	360-000-014	132	0.75	99.00	\$46.06	\$4,559.94	R1
522	RUBELMAN	CAMPBELL, DENNIS S & MARY J	360-000-015	90	0.75	67.50	\$46.06	\$3,109.05	R1
604	E NORTH ST	ROWELL, RODNEY & ANDREA	360-000-016	82	1	82.00	\$46.06	\$3,776.92	R1
608	E NORTH ST	KULMAN, TODD W	360-000-017	85	1	85.00	\$46.06	\$3,915.10	R1
612	E NORTH ST	PLAMP, KELLY S	360-000-018	82	1	82.00	\$46.06	\$3,776.92	R1
1411	KRUST	DRAKE, WM E & JANET L	360-000-019	89.92	0.75	67.44	\$46.06	\$3,106.29	R1
702	E NORTH ST	WOOD NICHOLAS J	541-000-043	66	0.75	49.50	\$46.06	\$2,279.97	R1
704	E NORTH ST	POLLION, JENNIFER J	541-000-042	66	1	66.00	\$46.06	\$3,039.96	R1
1409	WHITEHAVEN	WALTER, MARK & DEANA	193-000-001	152	0.75	114.00	\$46.06	\$5,250.84	R1
1408	WHITEHAVEN	SKODINSKI, CAMILLA K	193-000-016	100.06	0.75	75.05	\$46.06	\$3,456.57	R1
808	E NORTH ST	BURNSIDE, DENISE	197-000-022	66.04	1	66.04	\$46.06	\$3,041.80	R1
812	E NORTH ST	ZIMMERMAN, ROBERT H & CHERY	197-000-021	66.04	1	66.04	\$46.06	\$3,041.80	R1
816	E NORTH ST	GOODING, JASON E & JENNA E	197-000-020	66.04	1	66.04	\$46.06	\$3,041.80	R1
820	E NORTH ST	ST. JOHN, ASHLEY M	197-000-019	66.04	1	66.04	\$46.06	\$3,041.80	R1
900	E NORTH ST	CRANE, KEVIN J & KRISTY LYNN	197-000-018	66.04	1	66.04	\$46.06	\$3,041.80	R1
904	E NORTH ST	SAWER, GLENN H ET AL	197-000-017	71	1	71.00	\$46.06	\$3,270.26	R1
908	E NORTH ST	HUDAK, KRISTA D	197-000-016	65.04	1	65.04	\$46.06	\$2,995.74	R1
912	E NORTH ST	KIRBY KENNETH H & SANDRA S & SCOTT	197-000-015	97.08	0.75	72.81	\$46.06	\$3,353.63	R1
				2168.3		1890.54		\$87,078.04	

TOTAL ASSESSABLE FRONT FOOTAGE

4329.81

*ASSESSED AS COMMERCIAL

**ENGINEER'S ESTIMATE - POST BID
NORTH STREET**

15-Jan-20

RESO 4

E NORTH STREET FROM HICKORY TO GOULD ENGINEER'S ESTIMATE

DESCRIPTION	UNIT	QUANTITY	UNIT PRICE	AMOUNT	ELLLIGIBLE AMOUNT	CITY COST 60 PERCENT	ASSESSMENT	ASSESSMENT
							AT 40% RESIDENTIAL	AT 40% COMMERCIAL
Mobilization, Max \$85,500 (Road and Storm)	LSUM	0.6	\$ 85,500.00	\$ 51,300.00	\$ 51,300.00	\$ 30,780.00	\$ 20,520.00	\$ 20,520.00
Tree, Rem, 6 inch to 18 inch	EA	1	\$ 2,500.00	\$ 2,500.00		\$ -	\$ -	\$ -
Dr Structure, Rem	EA	20	\$ 350.00	\$ 7,000.00		\$ -	\$ -	\$ -
Sewer, Rem, Less than 24 inch	FT	1401	\$ 3.00	\$ 4,203.00		\$ -	\$ -	\$ -
Sewer, Rem, 24 inch to 48 inch	FT	32	\$ 30.00	\$ 960.00		\$ -	\$ -	\$ -
Curb and Gutter, Rem	FT	5275	\$ 4.50	\$ 23,737.50	\$ 23,737.50	\$ 14,242.50	\$ 9,495.00	\$ 9,495.00
Pavt, Rem	SYD	768	\$ 6.00	\$ 4,608.00	\$ 4,608.00	\$ 2,764.80	\$ 1,843.20	\$ 1,843.20
Sidewalk, Rem	SYD	252	\$ 5.00	\$ 1,260.00		\$ -	\$ -	\$ -
Embankment, CIP	CYD	1310	\$ 8.00	\$ 10,480.00		\$ -	\$ -	\$ -
Excavation, Earth	CYD	2100	\$ 12.00	\$ 25,200.00		\$ -	\$ -	\$ -
Subbase, CIP	CYD	148	\$ 18.77	\$ 2,777.96		\$ -	\$ -	\$ -
Subgrade Undercutting, Type II	CYD	200	\$ 25.00	\$ 5,000.00		\$ -	\$ -	\$ -
Erosion Control, Inlet Protection, Fabric Drop	EA	16	\$ 80.00	\$ 1,280.00	\$ 1,280.00	\$ 768.00	\$ 512.00	\$ 512.00
Aggregate Base, 6 inch, Modified	SYD	1682	\$ 10.45	\$ 17,576.90		\$ -	\$ -	\$ -
Aggregate Base, 8 inch, Modified	SYD	9082	\$ 13.15	\$ 119,428.30		\$ -	\$ -	\$ -
Maintenance Gravel	TON	100	\$ 30.00	\$ 3,000.00	\$ 3,000.00	\$ 1,800.00	\$ 1,200.00	\$ 1,200.00
Geotextile, Separator	SYD	10764	\$ 2.00	\$ 21,528.00		\$ -	\$ -	\$ -
Sewer, SDR-26, 10 inch, Tr Det B, Modified	FT	153	\$ 60.00	\$ 9,180.00		\$ -	\$ -	\$ -
Sewer, SDR-26, 12 inch, Tr Det B, Modified	FT	236	\$ 67.00	\$ 15,812.00		\$ -	\$ -	\$ -
Sewer, SDR-26, 15 inch, Tr Det B, Modified	FT	241	\$ 72.00	\$ 17,352.00		\$ -	\$ -	\$ -
Sewer, SDR-26, 18 inch, Tr Det B, Modified	FT	261	\$ 83.00	\$ 21,663.00		\$ -	\$ -	\$ -
Sewer, SDR-26, 24 inch, Tr Det B, Modified	FT	427	\$ 112.00	\$ 47,824.00		\$ -	\$ -	\$ -
Sewer Bulkhead, 12 inch	EA		\$ 100.00	\$ -		\$ -	\$ -	\$ -
Sewer Tap, 12 inch	EA		\$ 400.00	\$ -		\$ -	\$ -	\$ -
Sewer Tap, 18 inch	EA	1	\$ 500.00	\$ 500.00		\$ -	\$ -	\$ -
Dr Structure, Temp Lowering	EA	10	\$ 200.00	\$ 2,000.00	\$ 2,000.00	\$ 1,200.00	\$ 800.00	\$ 800.00
Dr Structure Cover, Adj, Case 1	EA	12	\$ 450.00	\$ 5,400.00	\$ 5,400.00	\$ 3,240.00	\$ 2,160.00	\$ 2,160.00
Dr Structure, Tap, 12 inch	EA	1	\$ 350.00	\$ 350.00		\$ -	\$ -	\$ -
Dr Structure Collar, Modified	EA	16	\$ 500.00	\$ 8,000.00	\$ 8,000.00	\$ 4,800.00	\$ 3,200.00	\$ 3,200.00
Dr Structure Cover, EJ 1040 w/ Vented Gasket Sealed Cover	EA	7	\$ 700.00	\$ 4,900.00	\$ 4,900.00	\$ 2,940.00	\$ 1,960.00	\$ 1,960.00
Dr Structure Cover, EJ 1040 w/ Solid Gasket Sealed Cover	EA	10	\$ 700.00	\$ 7,000.00	\$ 7,000.00	\$ 4,200.00	\$ 2,800.00	\$ 2,800.00
Dr Structure Cover, EJ 7000	EA	13	\$ 750.00	\$ 9,750.00	\$ 9,750.00	\$ 5,850.00	\$ 3,900.00	\$ 3,900.00
Dr Structure 36 inch dia, Modified	EA	12	\$ 1,500.00	\$ 18,000.00		\$ -	\$ -	\$ -
Dr Structure 48 inch dia, Modified	EA	7	\$ 2,000.00	\$ 14,000.00		\$ -	\$ -	\$ -
Dr Structure 60 inch dia, Modified	EA		\$ 3,000.00	\$ -		\$ -	\$ -	\$ -
Dr Structure 72 inch dia, Modified	EA	1	\$ 3,500.00	\$ 3,500.00		\$ -	\$ -	\$ -
HMA Surface, Rem	SYD	10906	\$ 2.00	\$ 21,812.00	\$ 21,812.00	\$ 13,087.20	\$ 4,362.40	\$ 6,543.60
Hand Patching	TON		\$ 130.30	\$ -	\$ -	\$ -	\$ -	\$ -
HMA, 3E3 @ 3.5"	TON	1923	\$ 67.70	\$ 130,187.10	\$ 130,187.10	\$ 78,112.26	\$ 14,878.53	\$ 44,635.58

**ENGINEER'S ESTIMATE - POST BID
NORTH STREET**

E NORTH STREET FROM HICKORY TO GOULD ENGINEER'S ESTIMATE

DESCRIPTION	UNIT	QUANTITY	UNIT PRICE	AMOUNT	ELLLIGIBLE AMOUNT	CITY COST 60 PERCENT	ASSESSMENT AT 40% RESIDENTIAL	ASSESSMENT AT 40% COMMERCIAL
HMA, 4E3 @ 1.5"	TON	824	\$ 85.90	\$ 70,781.60	\$ 70,781.60	\$ 42,468.96	\$ 28,312.64	\$ 28,312.64
HMA, 5E3 @ 1.5"	TON	824	\$ 92.80	\$ 76,467.20	\$ 76,467.20	\$ 45,880.32	\$ 30,586.88	\$ 30,586.88
HMA Approach	TON	5	\$ 103.40	\$ 517.00	\$ 517.00	\$ 310.20	\$ 206.80	\$ 206.80
Cement	TON		\$ 175.00	\$ -		\$ -	\$ -	\$ -
Saw Cutting	FT	100	\$ 4.00	\$ 400.00		\$ -	\$ -	\$ -
Driveway, Nonreinf Conc, 6 inch	SYD	875	\$ 28.00	\$ 24,500.00	\$ 24,500.00	\$ 14,700.00	\$ 9,800.00	\$ 9,800.00
Driveway, Nonreinf Conc, 9 inch	SYD	250	\$ 41.00	\$ 10,250.00		\$ -	\$ -	\$ -
Approach, CI II, LM	TON		\$ 50.00	\$ -	\$ -	\$ -	\$ -	\$ -
Curb and Gutter, Conc, Det F4	FT	5044	\$ 13.50	\$ 68,094.00	\$ 68,094.00	\$ 40,856.40	\$ 27,237.60	\$ 27,237.60
Curb and Gutter, Conc, Det F4, Modified	FT		\$ 16.00	\$ -		\$ -	\$ -	\$ -
Driveway Opening, Conc, Det M	FT	256	\$ 16.00	\$ 4,096.00		\$ -	\$ -	\$ -
Detectable Warning Surface, Modified	FT	66	\$ 68.00	\$ 4,488.00		\$ -	\$ -	\$ -
Sidewalk Ramp, Conc, 7 inch	SFT	997	\$ 5.15	\$ 5,134.55		\$ -	\$ -	\$ -
Sidewalk, Conc, 4 inch	SFT	1028	\$ 3.15	\$ 3,238.20		\$ -	\$ -	\$ -
Sidewalk, Conc, 6 inch	SFT	2062	\$ 3.35	\$ 6,907.70		\$ -	\$ -	\$ -
Sidewalk, Conc, 9 inch	SFT	1100	\$ 4.15	\$ 4,565.00		\$ -	\$ -	\$ -
Valve Box, Adj	EA	1	\$ 250.00	\$ 250.00		\$ -	\$ -	\$ -
Sanitary Serv Conflict	EA	3	\$ 1,000.00	\$ 3,000.00		\$ -	\$ -	\$ -
Abandoned Gas Main Conflict	EA	5	\$ 200.00	\$ 1,000.00		\$ -	\$ -	\$ -
Barricade, Type III, High Intensity, Double Sided, Furn & Oper	EA	12	\$ 90.00	\$ 1,080.00		\$ -	\$ -	\$ -
Pedestrian Type II Barricade, Temp	EA	15	\$ 100.00	\$ 1,500.00		\$ -	\$ -	\$ -
Lighted Arrow, Type C, Furn & Oper	EA	1	\$ 350.00	\$ 350.00		\$ -	\$ -	\$ -
Minor Traf Devices, Max \$10,000	LSUM	0.6	\$ 10,000.00	\$ 6,000.00	\$ 6,000.00	\$ 3,600.00	\$ 2,400.00	\$ 2,400.00
Plastic Drum, High Intensity, Furn & Oper	EA	50	\$ 16.50	\$ 825.00		\$ -	\$ -	\$ -
Sign, Type B, Temp, Prismatic, Furn & Oper	SFT	373	\$ 3.45	\$ 1,286.85		\$ -	\$ -	\$ -
Sign, Portable, Changeable Message, Furn & Oper	EA	1	\$ 2,150.00	\$ 2,150.00		\$ -	\$ -	\$ -
Turf Establishment, Performance	SYD	3366	\$ 4.75	\$ 15,988.50		\$ -	\$ -	\$ -
Post, Steel, 3lb	FT	480	\$ 7.50	\$ 3,600.00		\$ -	\$ -	\$ -
Sign, Type III, Erect, Salv	EA	6	\$ 60.00	\$ 360.00		\$ -	\$ -	\$ -
Sign, Type III, Rem	EA	14	\$ 40.00	\$ 560.00		\$ -	\$ -	\$ -
Sign, Type IIIB	SFT	150	\$ 17.25	\$ 2,587.50		\$ -	\$ -	\$ -
Sign, Type V, Rem	EA	1	\$ 45.00	\$ 45.00		\$ -	\$ -	\$ -
Sign, Type VB	SFT	8	\$ 24.50	\$ 196.00		\$ -	\$ -	\$ -
Pavt Mrkg, Ovly Cold Plastic, 6 inch, Crosswalk	FT	410	\$ 2.50	\$ 1,025.00		\$ -	\$ -	\$ -
Pavt Mrkg, Ovly Cold Plastic, 24 inch, Stop Bar	FT	110	\$ 11.00	\$ 1,210.00		\$ -	\$ -	\$ -
Pavt Mrkg, Ovly Cold Plastic, Rt Turn Arrow Sym	EA	2	\$ 140.00	\$ 280.00		\$ -	\$ -	\$ -
Pavt Mrkg, Ovly Cold Plastic, Thru and Lt Turn Arrow Sym	EA	2	\$ 170.00	\$ 340.00		\$ -	\$ -	\$ -
Pavt Mrkg, Waterborne, 4 inch, White	FT	165	\$ 0.29	\$ 47.85		\$ -	\$ -	\$ -
Pavt Mrkg, Waterborne, 4 inch, Yellow	FT	4420	\$ 0.29	\$ 1,281.80		\$ -	\$ -	\$ -
Post, Mailbox	EA	18	\$ 100.00	\$ 1,800.00		\$ -	\$ -	\$ -

**ENGINEER'S ESTIMATE - POST BID
NORTH STREET**

E NORTH STREET FROM HICKORY TO GOULD ENGINEER'S ESTIMATE

DESCRIPTION	UNIT	QUANTITY	UNIT PRICE	AMOUNT	ELIGIBLE AMOUNT	CITY COST 60 PERCENT	ASSESSMENT AT 40% RESIDENTIAL	ASSESSMENT AT 40% COMMERCIAL
Audio Visual Filming	LSUM	0.6	\$ 6,000.00	\$ 3,600.00		\$ -	\$ -	\$ -
SUB TOTALS				\$ 968,872.51	\$ 519,334.40	\$ 311,600.64	\$ 166,175.05	\$ 198,113.30
ENGINEERING AT 15% ASSESSABLE COST				\$ 145,330.88	\$ 77,900.16	\$ 46,740.10	\$ 24,926.26	\$ 29,716.99
ADMINISTRATIVE AT 5% ASSESSABLE COST				\$ 48,443.63	\$ 25,966.72	\$ 15,580.03	\$ 8,308.75	\$ 9,905.66
GRAND TOTALS				\$ 1,162,647.01	\$ 623,201.28	\$ 373,920.77	\$ 199,410.05	\$ 237,735.96